

# INSTALLATION INSTRUCTIONS

## Product

DS-150 VEHICLE BASE

TOYOTA TACOMA (2005+)  
TOYOTA HIGHLANDER (2008+)

## Revision

Rev B

## Form #

INST-308

Printing Spec: PS-001

The DS-150 is a No Holes Bored base that mounts to the passenger side seat bolts. The mount utilizes an offset riser to position the pole closer to the transmission hump. Use of a LAC-03 W/U-DS Support Brace is strongly recommended.

### Installation:

1. Attach the Offset Riser to the base using (4) .38-16 x .75 long carriage bolts, (4) .38 flat washers and (4) .38-16 hex nuts, supplied in hardware bag 7120-0003. Insert the carriage bolts from the bottom side with washers and nuts on the top side.
2. Remove the two front seat bolts that hold the passenger seat to the floor.
3. Place the base over the seat mounting brackets, so the slots in the base align with the holes in the seat brackets and the floor. The base mounts to the outside of the seat brackets.
4. Install (2) M10-1.25 x 40mm seat bolts and (2) .38 flat washers, supplied in hardware bag 7120-0364, thru the base and seat brackets, securely to the floor.

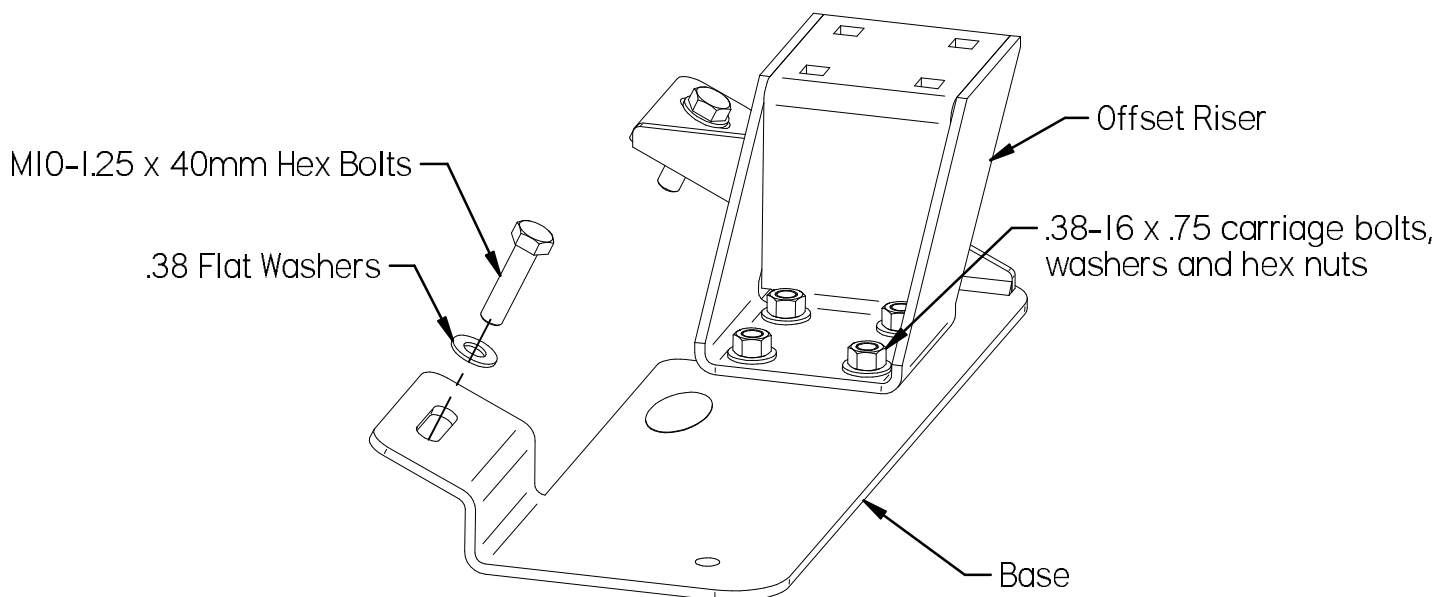

#### Product Mounting Disclaimer

Gamber-Johnson is not liable under any theory of contract or tort law for any loss, damage, personal injury, special, incidental or consequential damages for personal injury or other damage of any nature arising directly or indirectly as a result of the improper installation or use of its products in vehicle or any other application. In order to safely install and use Gamber-Johnson products full consideration of vehicle occupants, vehicle systems (i.e., the location of fuel lines, brakes lines, electrical, drive train or other systems), air-bags and other safety equipment is required. Gamber-Johnson specifically disclaims any responsibility for the improper use or installation of its products not consistent with the original vehicle manufactures specifications and recommendations, Gamber-Johnson product instruction sheets, or workmanship standards as endorsed through the Gamber-Johnson Certified Installer Program.

©Copyright 2012 Gamber-Johnson, LLC

If you need assistance or have questions, call Gamber-Johnson at 1-800-456-6868

1/1