



2020+ Ford Transit Radio Dashmount for XTL5000

User Guide

Description	Part Number
2020+ Ford Transit Radio Dashmount Plate	40.C235.051
Motorola XTL5000 Dashmount Faceplate	AS4.C235.201

www.precisionmounts.com

call us at 1-888-869-7652 | info@precisionmounts.com

PARTS & HARDWARE DESCRIPTION

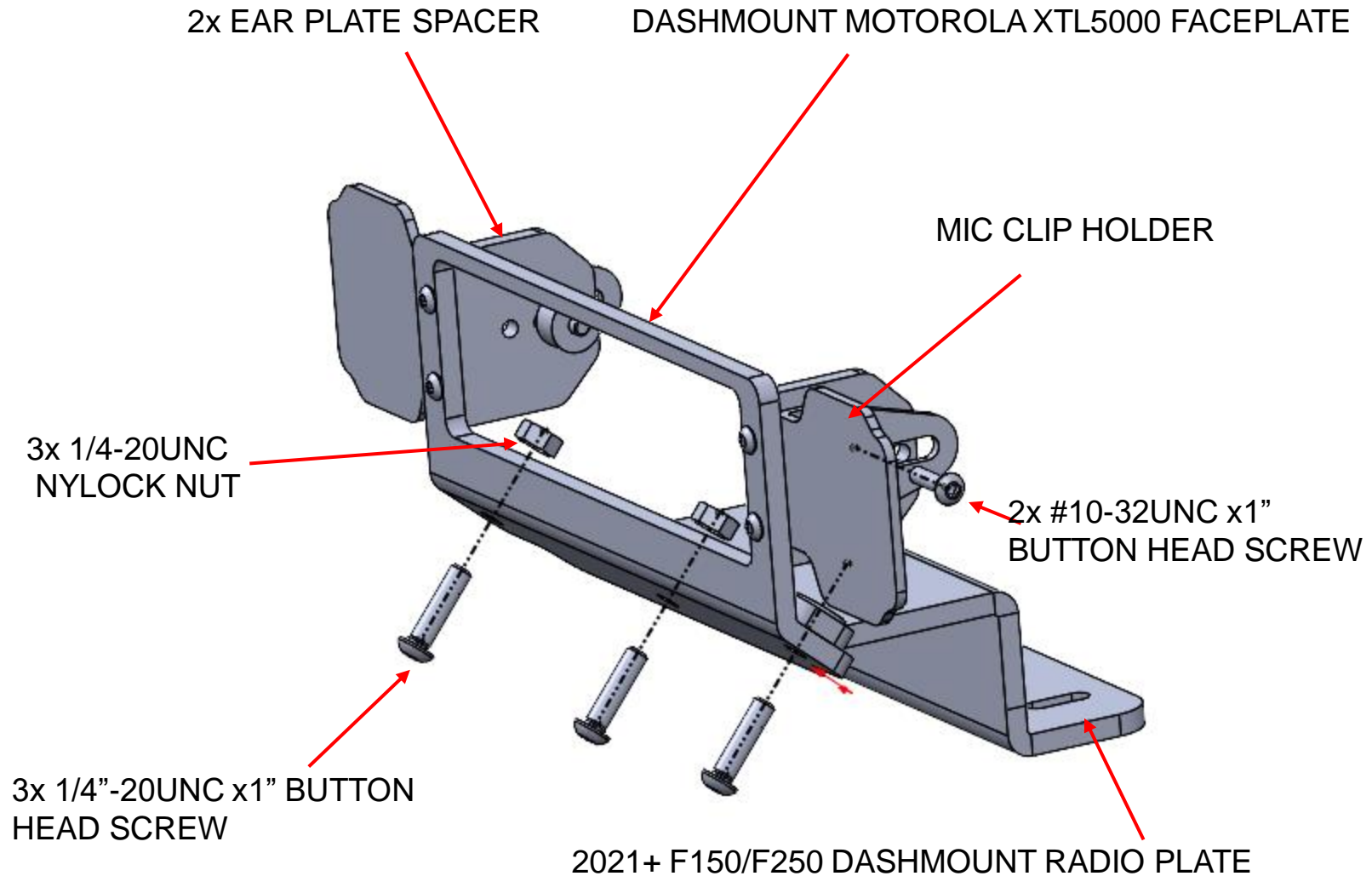

- DASHMOUNT RADIO PLATE: This plate attaches to vehicle dash over the trim panel of vehicle dash.
- DASHMOUNT MOTOROLA XTL5000 FACEPLATE: The plate attaches to the dashmount radio bracket and accommodates the XTL5000 radio.
- MIC CLIP HOLDER(90.C128.166): The MIC clip helps in attaching and holding the microphone. It can be purchased separately.
- **Other radio head faceplates are also available. Please contact PMT for more information**

INSTALLATION INSTRUCTIONS

40.C235.051 + AS4.C235.201

2020+ Ford Transit Radio Dashmount Plate & Motorola XTL5000 Dashmount Faceplate

Tools and hardware required:

- Socket set suitable for #1/4-20 Hex Allen wrench
- 1/4-20 Hex socket head wrench
- $\Phi 1/4$ " Drill
- 1/4" bolts and nuts

Step 1: Gently pry and remove the OEM trim on top of the dash



Step 2: Put the dashmount radio plate on top, and mark the holes



Step 3: Drill the marked holes by using $\Phi 1/4"$ drill



Step 4: Assemble the radio head into the faceplate



#10-32UNC x1" BUTTON
HEAD SCREW

EAR PLATE SPACER

EAR PLATE SPACER

#10-32UNC x1" BUTTON
HEAD SCREW

Step 5: Place the plate assembly on top of the tray, and use the 1/4" bolts and nuts tighten it.(0.75" or longer bolts and Loctite are recommended)

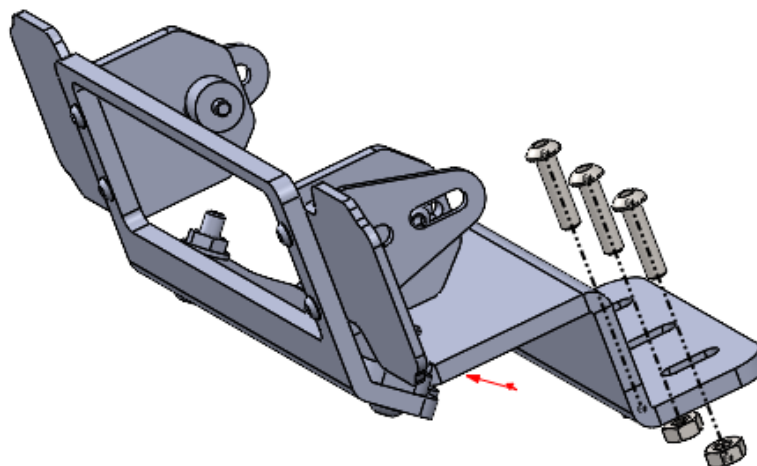

Step 8: Put the whole assembly back to the vehicle and make sure everything is tight and secure

