



## 2025+ FORD EXPEDITION CONSOLE USER GUIDE

Description	Part Number
2025+ FORD EXPEDITION CONSOLE	AS4.C256.101
2025+ FORD EXPEDITION CONSOLE WITH MOUSETRAP	AS4.C256.102
2025+ FORD EXPEDITION CONSOLE BOX	AS4.C256.105

### Product Mounting Disclaimer

Precision Mounting Technologies Ltd (PMT) are not liable under any theory of contract or tort law for any loss, damage, personal injury, special, incidental or consequential damages for personal injury or other damage of any nature arising directly or indirectly as a result of the improper installation or use of its products in vehicle or any other application. In order to safely install and use PMT products full consideration of vehicle occupants, vehicle systems (i.e., the location of fuel lines, brake lines, electrical, drive train or other systems), air-bags and other safety equipment is required. PMT specifically disclaims any responsibility for the improper use or installation of its products not consistent with original vehicle manufactures' specifications and recommendations, PMT product instruction sheets, or workmanship standards as endorsed through PMT policies and EULA.



# PRODUCT VISUAL



# PARTS & HARDWARE DESCRIPTION

AS4.C256.105

ITEM NO.	DESCRIPTION	QUANTITY
1	CONSOLE SHELL	1
2	MOUNTING BRACKETS	2
3	LIND POWER SUPPLY BRACKET	1
4	12 VOLT WIRING HARNESS	1
5	12 VOLT SOCKET	2
6	DOME PLUGS	2
7	EDGE TRIM	1
8	1/4" – 20 X 3/4" CARRIAGE BOLTS	8
9	1/4" X 5/8" STEEL WASHER	8
10	1/4" – 20 SERRATED FLANGE NUT	8
11	10-24 X 1/2" HEX HEAD SCREW	4

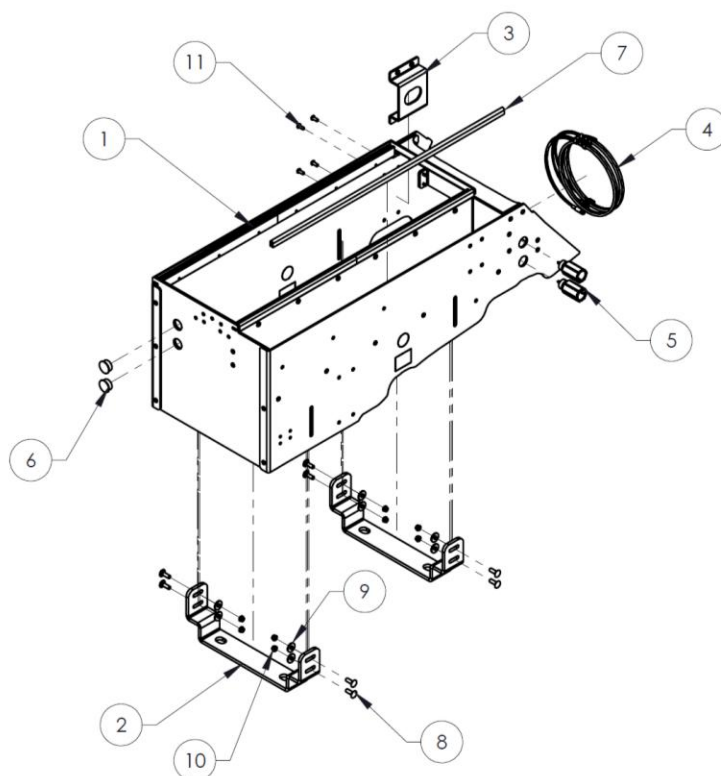

# PARTS & HARDWARE DESCRIPTION CONT.

AS4.C256.101

ITEM NO.	DESCRIPTION	QUANTITY
1	<b>AS4.C256.105</b> CONSOLE BOX	1
2	SINGLE ARMREST & CUPHOLDER	1

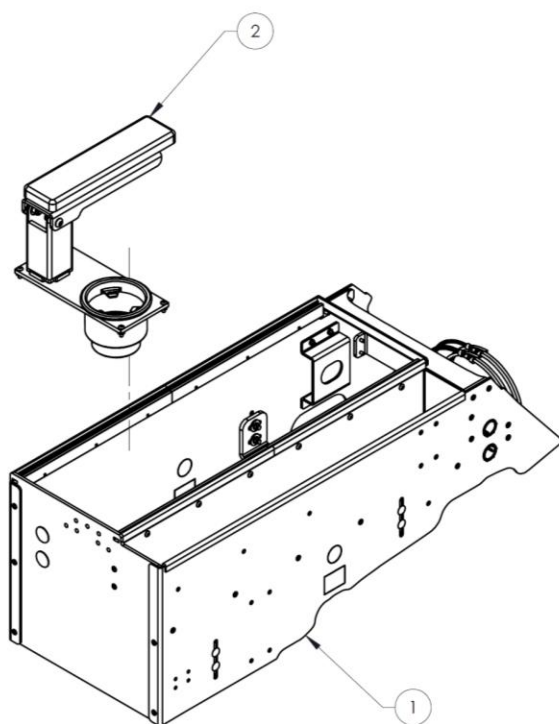

# PARTS & HARDWARE DESCRIPTION CONT.

AS4.C256.102

ITEM NO.	DESCRIPTION	QUANTITY
1	<b>AS4.C256.101</b> CONSOLE	1
2	MOUSETRAP/MONGOOSE SIDE MOUNT	1
3	MOUSETRAP WITH MULTI-PATTERN TILT	1
4	1/4" – 20 X 3/4" CARRIAGE BOLT	5
5	1/4" – 20 NYLOK NUT	5

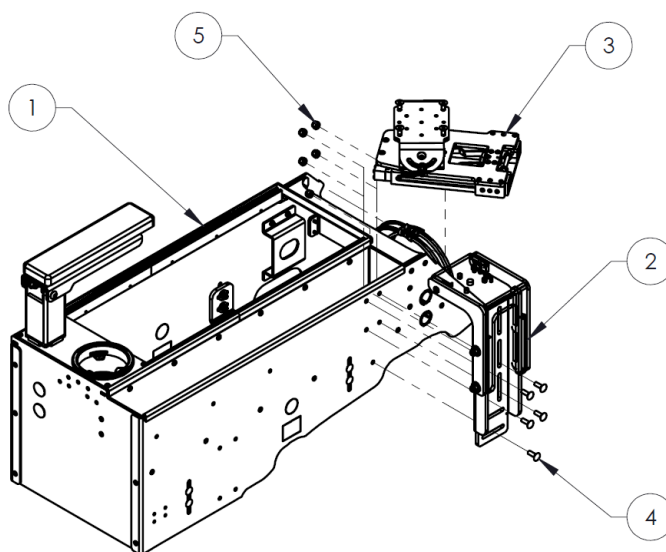

# INSTALLATION INSTRUCTIONS

## Tools and hardware required:

- Metric and Imperial socket sets and ratchet
- T50 and T55 Torx sockets
- Allen keys

## Step 1

Remove OEM console if present.

## Step 2

Install the supplied mounting brackets to the vehicle using the OEM Torx head screws.

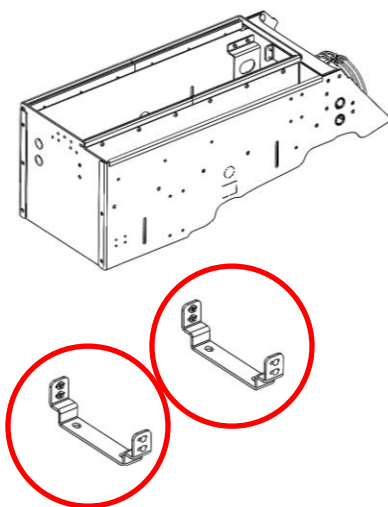

## Step 3

Install the console to the mounting brackets with the supplied hardware outlined on page 3.

## Step 4

Install any faceplates and accessories to complete the installation of the PMT console. The PMT Face Plate Installation Guide can be found at <https://www.precisionmounts.com/product-information>