



FORD F-SERIES AMPS DASH MOUNT ADAPTER - FRONT FACING INSTALLATION GUIDE

TO BE USED WITH AS4.C235.014

Description	Part Number
FORD F-SERIES AMPS DASH MOUNT ADAPTER - FRONT FACING	AS4.C235.016

Product Mounting Disclaimer

Precision Mounting Technologies Ltd (PMT) are not liable under any theory of contract or tort law for any loss, damage, personal injury, special, incidental or consequential damages for personal injury or other damage of any nature arising directly or indirectly as a result of the improper installation or use of its products in vehicle or any other application. In order to safely install and use PMT products full consideration of vehicle occupants, vehicle systems (i.e., the location of fuel lines, brake lines, electrical, drive train or other systems), air-bags and other safety equipment is required. PMT specifically disclaims any responsibility for the improper use or installation of its products not consistent with original vehicle manufactures' specifications and recommendations, PMT product instruction sheets, or workmanship standards as endorsed through PMT policies and EULA.



PRODUCT VISUAL



PARTS & HARDWARE DESCRIPTION

AS4.C235.016

ITEM NO.	DESCRIPTION	QUANTITY
1	AMPS Front Facing Adapter	1
2	AMPS Front Facing Spacer	2
3	Protective Foam Tape	2
4	$\frac{1}{4}$ x 1- $\frac{1}{4}$ Hex Carriage Bolt	4
5	$\frac{1}{4}$ - 20 Serrated Flange Nut	4
6	$\frac{1}{4}$ Flat Washer	4

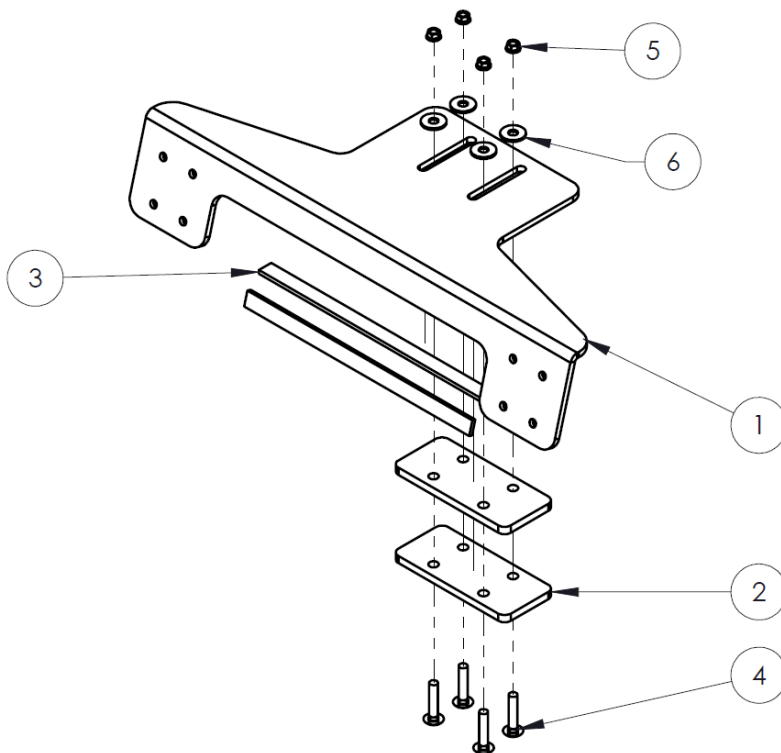

INSTALLATION INSTRUCTIONS

Tools and hardware required:

- Imperial socket sets and ratchet
- Imperial allen keys

Step 1

Remove the top plate of AS4.C235.014 by removing the 4 countersunk screws.



Step 2

Attach the AMPS front facing adapter with the 2 sandwich plates to the top plate of AS4.C235.014 with the provided hardware. Note where the carriage bolts are located. Only tighten **hand tight** at this stage, this will allow for easy adjustability.

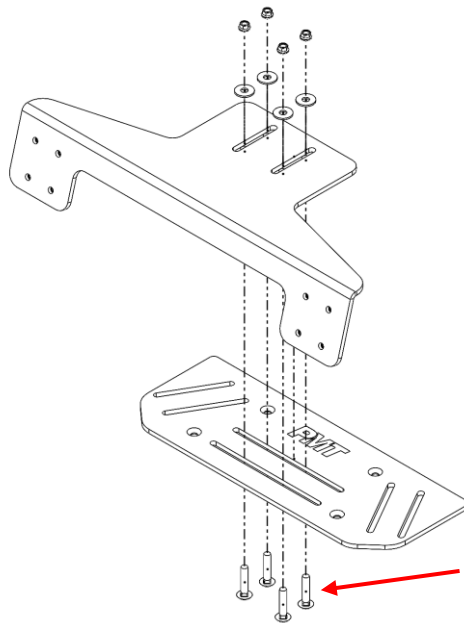

1/4 - 20 Carriage Bolts

INSTALLATION INSTRUCTIONS

Step 3

Attach the completed assembly from step 2 to the middle bracket of AS4.C235.014. Using the countersunk screws removed in step 1.

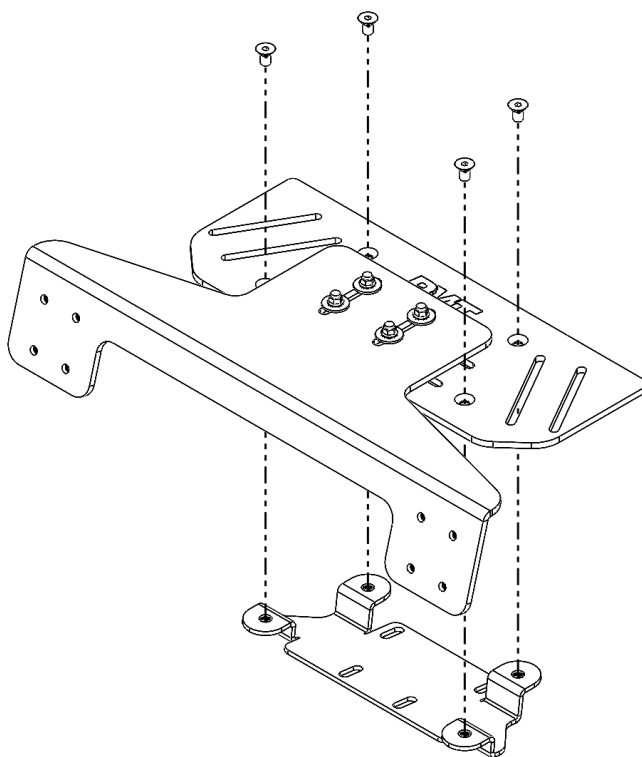

Step 4

Adjust the front facing bracket assembly to the desired location and then tighten the ¼ - 20 serrated flange nuts to the desired final torque.