



FORD F SERIES REAR UNDERSEAT STORAGE VAULT USER GUIDE

Description	Part Number
FORD F SERIES REAR UNDERSEAT STORAGE VAULT – BOTH SIDES	AS4.C128.300
FORD F SERIES REAR UNDERSEAT STORAGE VAULT – SHORT SIDE	AS4.C128.300-1
FORD F SERIES REAR UNDERSEAT STORAGE VAULT – LONG SIDE	AS4.C128.300-2

Product Mounting Disclaimer

Precision Mounting Technologies Ltd (PMT) are not liable under any theory of contract or tort law for any loss, damage, personal injury, special, incidental or consequential damages for personal injury or other damage of any nature arising directly or indirectly as a result of the improper installation or use of its products in vehicle or any other application. In order to safely install and use PMT products full consideration of vehicle occupants, vehicle systems (i.e., the location of fuel lines, brake lines, electrical, drive train or other systems), air-bags and other safety equipment is required. PMT specifically disclaims any responsibility for the improper use or installation of its products not consistent with original vehicle manufactures' specifications and recommendations, PMT product instruction sheets, or workmanship standards as endorsed through PMT policies and EULA.



DESCRIPTION OF THE PARTS

Under Seat Vault For
Ford F Series – Short Side

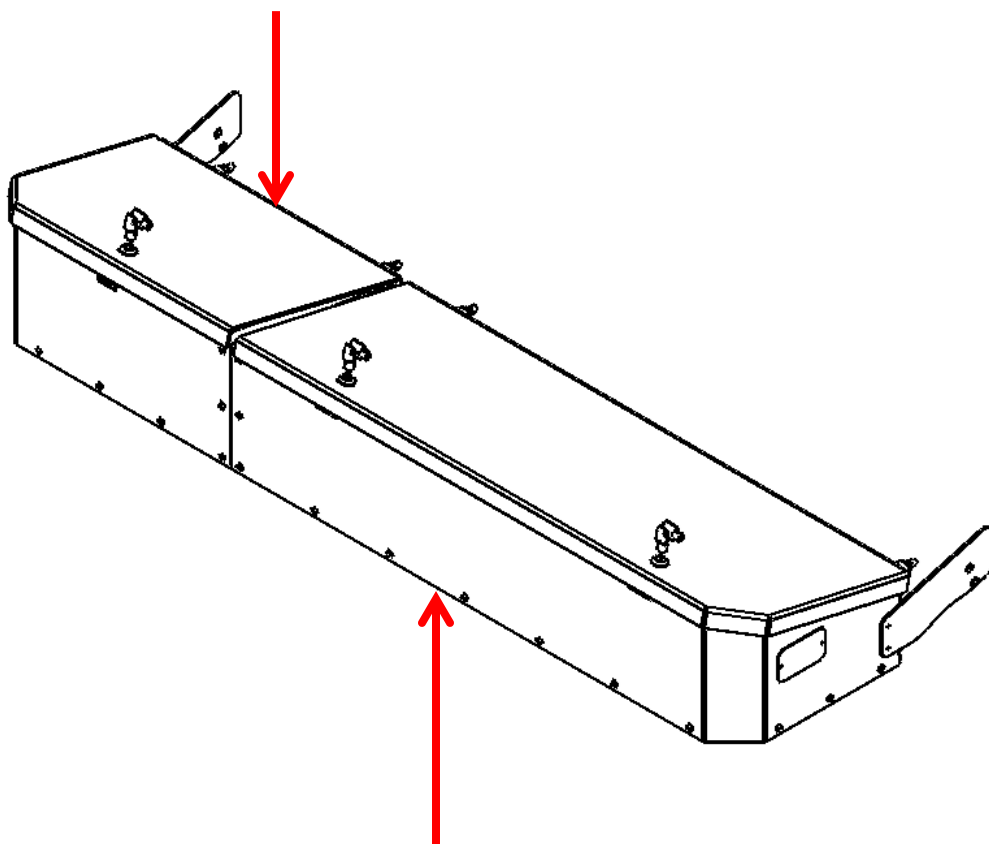

Under Seat Vault For Ford
F Series – Long Side

DESCRIPTION OF THE PARTS

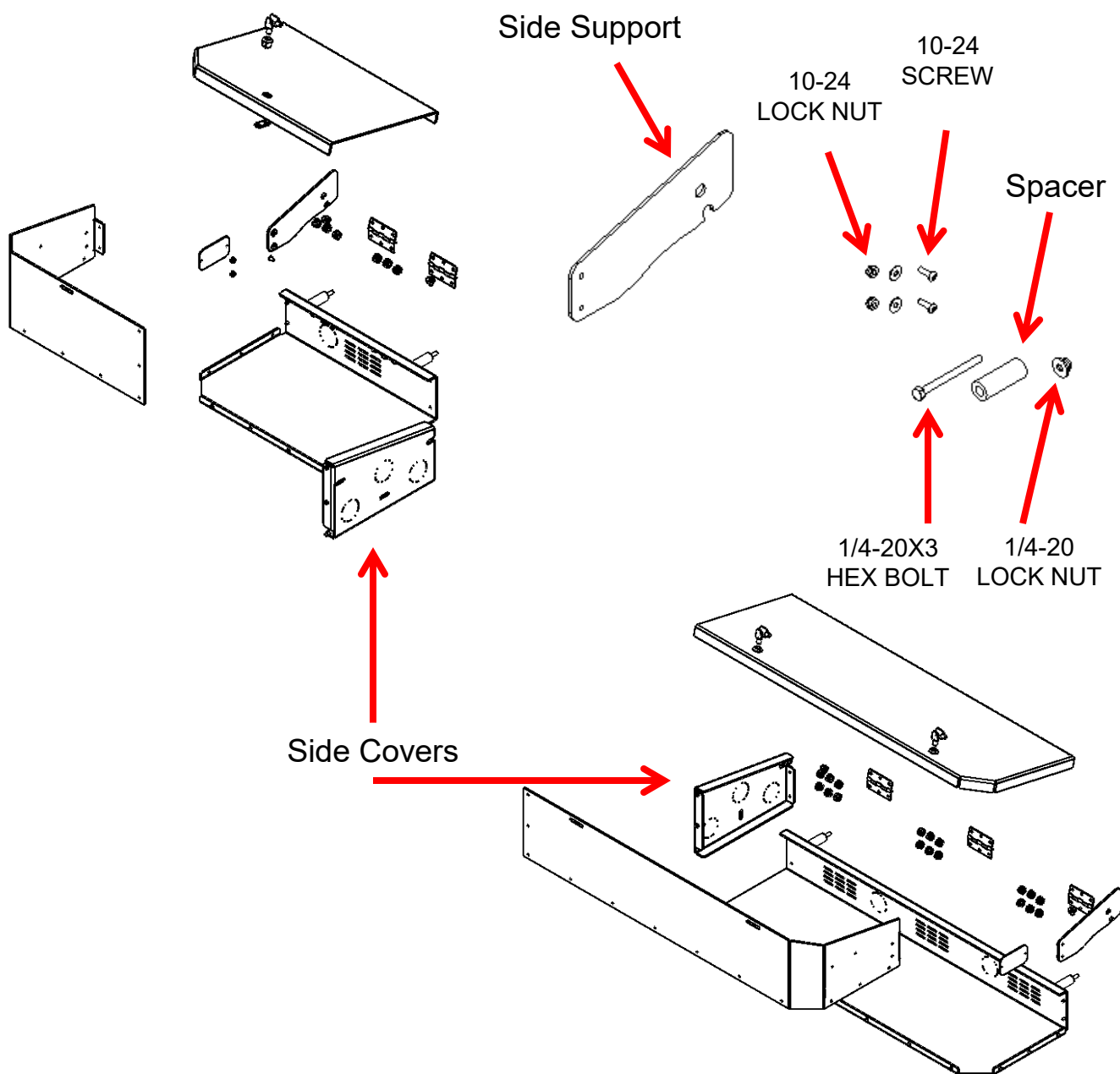

INSTALLATION INSTRUCTIONS

Tools and hardware required:

- Socket set suitable for #1/4-20 wrench
- Adjustable wrench

Installation parts:

Quantity	Description
1	Ford F Series Rear Under seat Storage Vault – S
1	Ford F Series Rear Under seat Storage Vault – L

Step 1

If there is an OEM under seat storage, uninstall it by removing the 4 OEM nuts. Then, Place the Under Seat Vault into vehicle.



INSTALLATION INSTRUCTIONS

Step 2

Place the spacer between the Vault and the seat base. Slide the bolt through the spacer and into the seat base.



Step 2.1

Add ¼"-20 Lock Nut and washer to the end of the bolt and leave it loose.



Step 2.2

Repeat the process for the remaining bolt and nuts (Total Four).



INSTALLATION INSTRUCTIONS

Step 2.3

Tighten all the hardware



Step 3

Uninstall the seat belt using a proper wrench.



Step 3.1

Install the side supports using socket set suitable for #10-24 screw.



INSTALLATION INSTRUCTIONS

Step 3.2
Install the seatbelt



Step 3.3
Attach the two sides using the carriage bolts



INSTALLATION INSTRUCTIONS



The installation is now complete.