



## 2020+ FORD POLICE INTERCEPTOR UTILITY CENCOM/PATH FINDER/ VTEC LIGHT AND SIREN ONLY DASH MOUNT USER GUIDE

Description	Part Number
2020+ FORD POLICE INTERCEPTOR UTILITY CENCOM/PATH FINDER/ VTEC LIGHT AND SIREN ONLY DASH MOUNT	AS4.C235.301 / AS4.C235.302 / AS4.C235.303

### Product Mounting Disclaimer

Precision Mounting Technologies Ltd (PMT) are not liable under any theory of contract or tort law for any loss, damage, personal injury, special, incidental or consequential damages for personal injury or other damage of any nature arising directly or indirectly as a result of the improper installation or use of its products in vehicle or any other application. In order to safely install and use PMT products full consideration of vehicle occupants, vehicle systems (i.e., the location of fuel lines, brake lines, electrical, drive train or other systems), air-bags and other safety equipment is required. PMT specifically disclaims any responsibility for the improper use or installation of its products not consistent with original vehicle manufactures' specifications and recommendations, PMT product instruction sheets, or workmanship standards as endorsed through PMT policies and EULA.



# DESCRIPTION OF PARTS

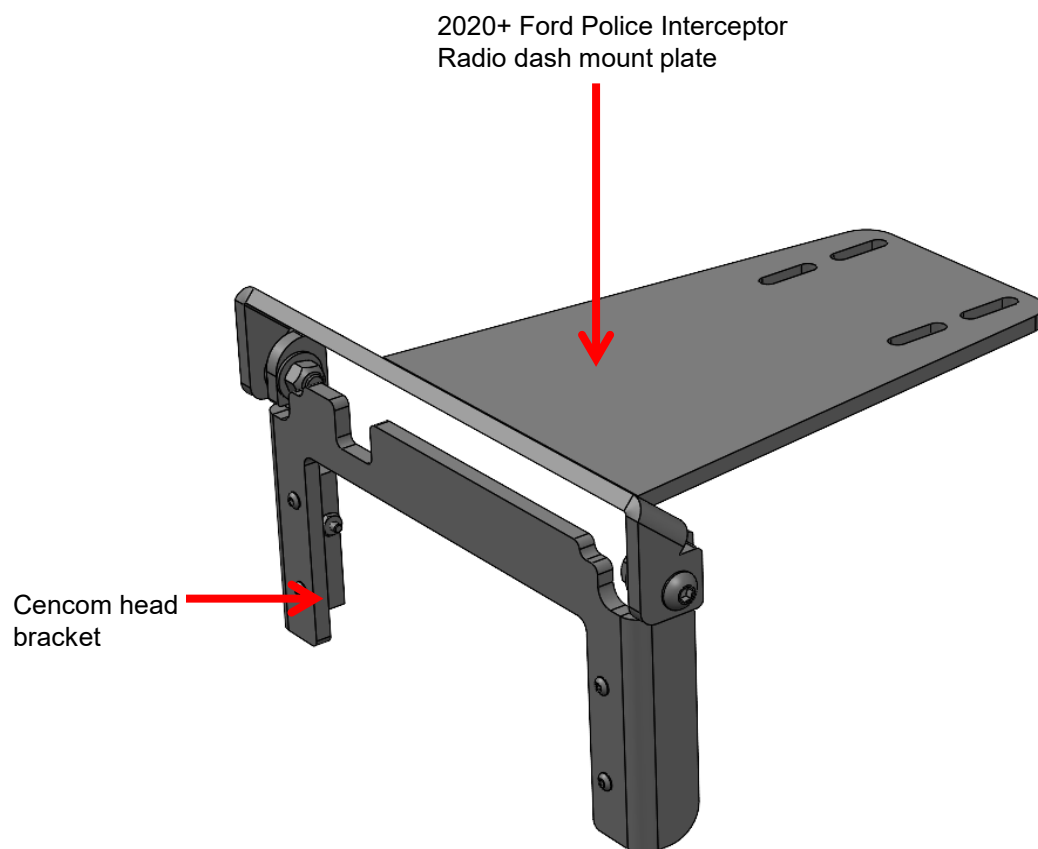

- **Dash Mount Radio Plate:** This plate attaches to vehicle dash over the trim panel of vehicle dash.
- **Cencom Head Bracket:** This bracket attaches to the dash plate and accommodates the Cencom signal device

# INSTALLATION INSTRUCTIONS

## Tools and hardware required:

- Allen key set suitable for #1/4-20 and M5 heads.
- 1/4-20 Hex socket head wrench

## Fastener Torque Specifications

- 1/4-20 Hex Heads - 49-66 ft-lbs
- M5 Socket button head - 8-15 ft-lbs

**Note:** the pictures used/shown here are only for CENCOM HEAD

## Step 1

Remove the dash tray OEM mounting holes hardware by using M5 socket head allen key as shown in Pic 1 below.



**Pic 1**

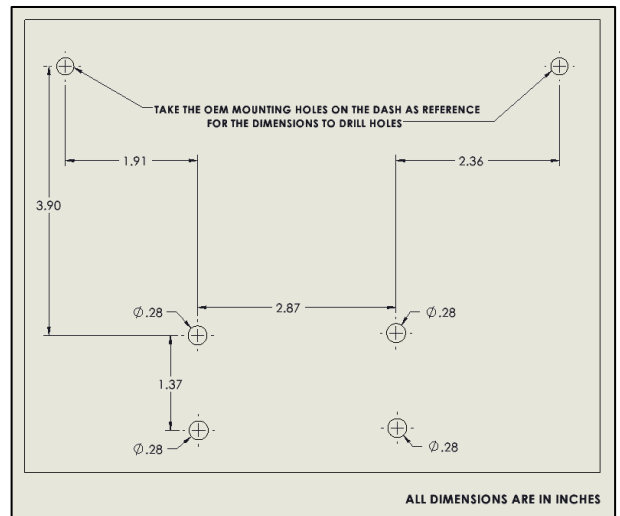

**Pic 2**

## Step 2

Use the dimensions shown in Pic 2 to Drill 4x #1/4-20 clearance holes on the dash tray and plate beneath the tray as per the location of 4 holes

# INSTALLATION INSTRUCTIONS

## Step 2.1

Ensure to reflect the drill holes **through the plate – underneath the dash mount tray** shown in Pic 4. Pic 4 does not show the holes on the plate, the holes have to be drilled by the installer as per the dimensions outlined in after proper alignment as shown in Pic 4.

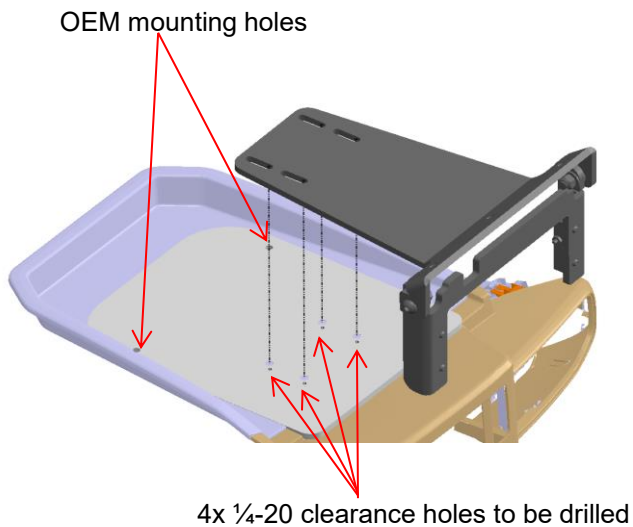

**Pic 3**

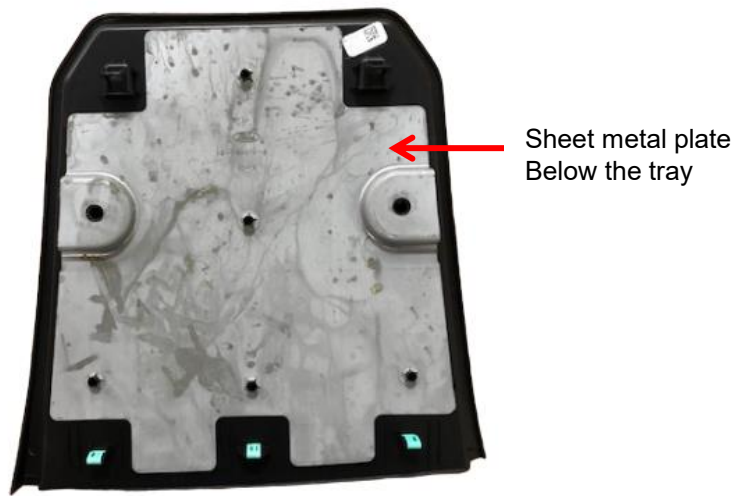

**Pic 4**

# INSTALLATION INSTRUCTIONS

## Step 3

Use 4x 1/4-20 Hex head bolt with nuts supplied to assemble the dash mount unit to the OEM dash tray as shown in picture below.

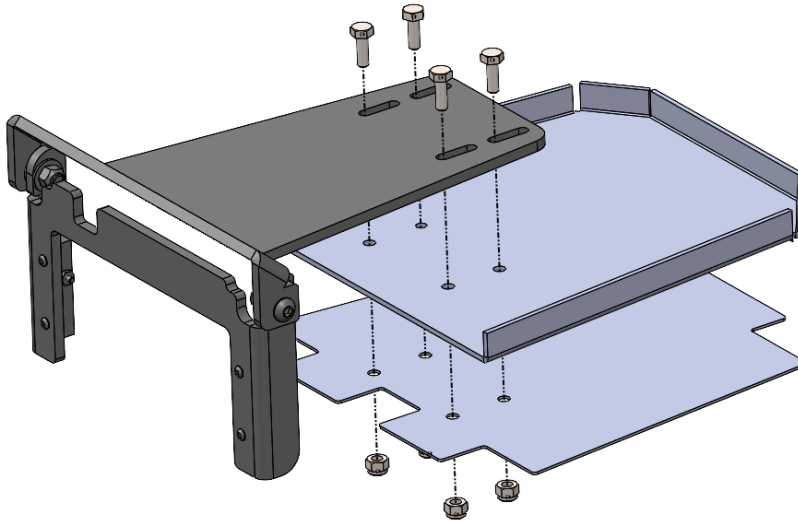

**Pic 5**

## Step 4

Assemble the unit- dash mount with OEM dash tray on to the vehicle dash by using the M5 screws – which were removed in Step 1, the final installation looks as shown below.



**Pic 6**