



## POSH K9 CARD READER CF33 LAPTOP PLATE INSTALLATION GUIDE

Description	Part Number
POSH K9 CARD READER CF33 LAPTOP PLATE	AS5.P100.001

### Product Mounting Disclaimer

Precision Mounting Technologies Ltd (PMT) are not liable under any theory of contract or tort law for any loss, damage, personal injury, special, incidental or consequential damages for personal injury or other damage of any nature arising directly or indirectly as a result of the improper installation or use of its products in vehicle or any other application. In order to safely install and use PMT products full consideration of vehicle occupants, vehicle systems (i.e., the location of fuel lines, brake lines, electrical, drive train or other systems), air-bags and other safety equipment is required. PMT specifically disclaims any responsibility for the improper use or installation of its products not consistent with original vehicle manufactures' specifications and recommendations, PMT product instruction sheets, or workmanship standards as endorsed through PMT policies and EULA.



# PARTS & HARDWARE DESCRIPTION

AS5.P100.001

ITEM NO.	DESCRIPTION	QUANTITY
1	POSH mounting plate	1
2	1/4-20x7/8 Counter sunk screw	2
3	1/4-20 Nylok nut	2

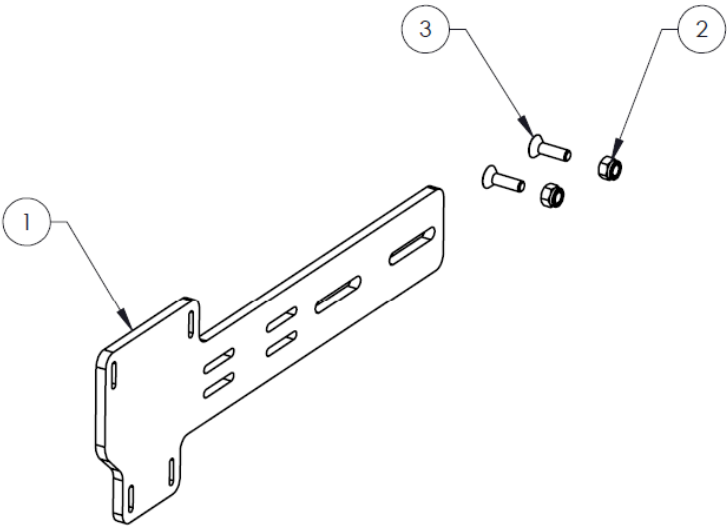

# INSTALLATION INSTRUCTIONS

## Step 1

Remove the CF33 laptop mounting plate to access the countersunk holes.

## Step 2

Attach the POSH mounting plate to the CF33 laptop mounting plate via the top countersunk holes with the provided hardware.

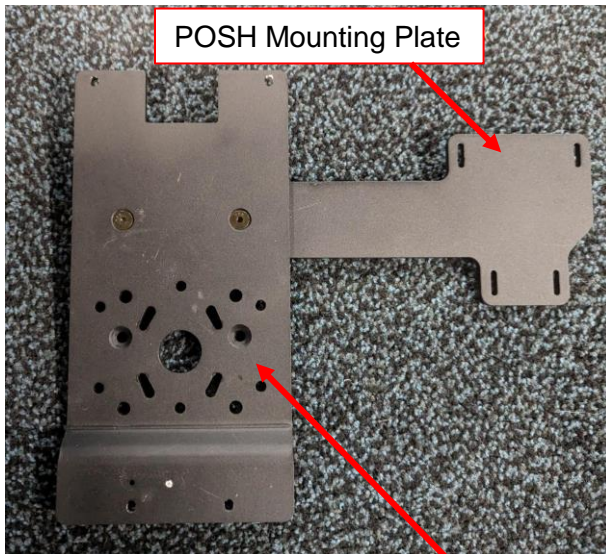

CF33 Laptop Mounting Plate

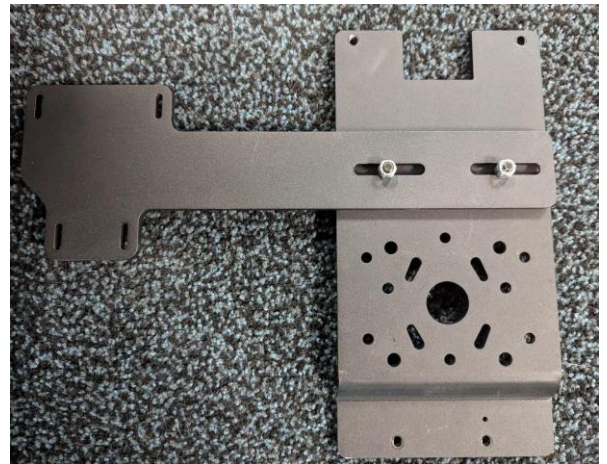

## Step 3

Reattach the CF33 laptop mounting plate to the CF33 dock.

## Step 4

Attach the POSH card reader to the POSH mounting plate.