



CLAMSHELL FOR GAMBER-JOHNSON UNIVERSAL USB-C DOCKING STATION USER GUIDE

Description	Part Number
Clamshell For Gamber-Johnson Universal USB-C Docking Station	AS7.C100.020

Product Mounting Disclaimer

Precision Mounting Technologies Ltd (PMT) are not liable under any theory of contract or tort law for any loss, damage, personal injury, special, incidental or consequential damages for personal injury or other damage of any nature arising directly or indirectly as a result of the improper installation or use of its products in vehicle or any other application. In order to safely install and use PMT products full consideration of vehicle occupants, vehicle systems (i.e., the location of fuel lines, brake lines, electrical, drive train or other systems), air-bags and other safety equipment is required. PMT specifically disclaims any responsibility for the improper use or installation of its products not consistent with original vehicle manufactures' specifications and recommendations, PMT product instruction sheets, or workmanship standards as endorsed through PMT policies and EULA.



ASSEMBLY STEP 1

- Remove handle and two screws shown below to detach the rotation plate

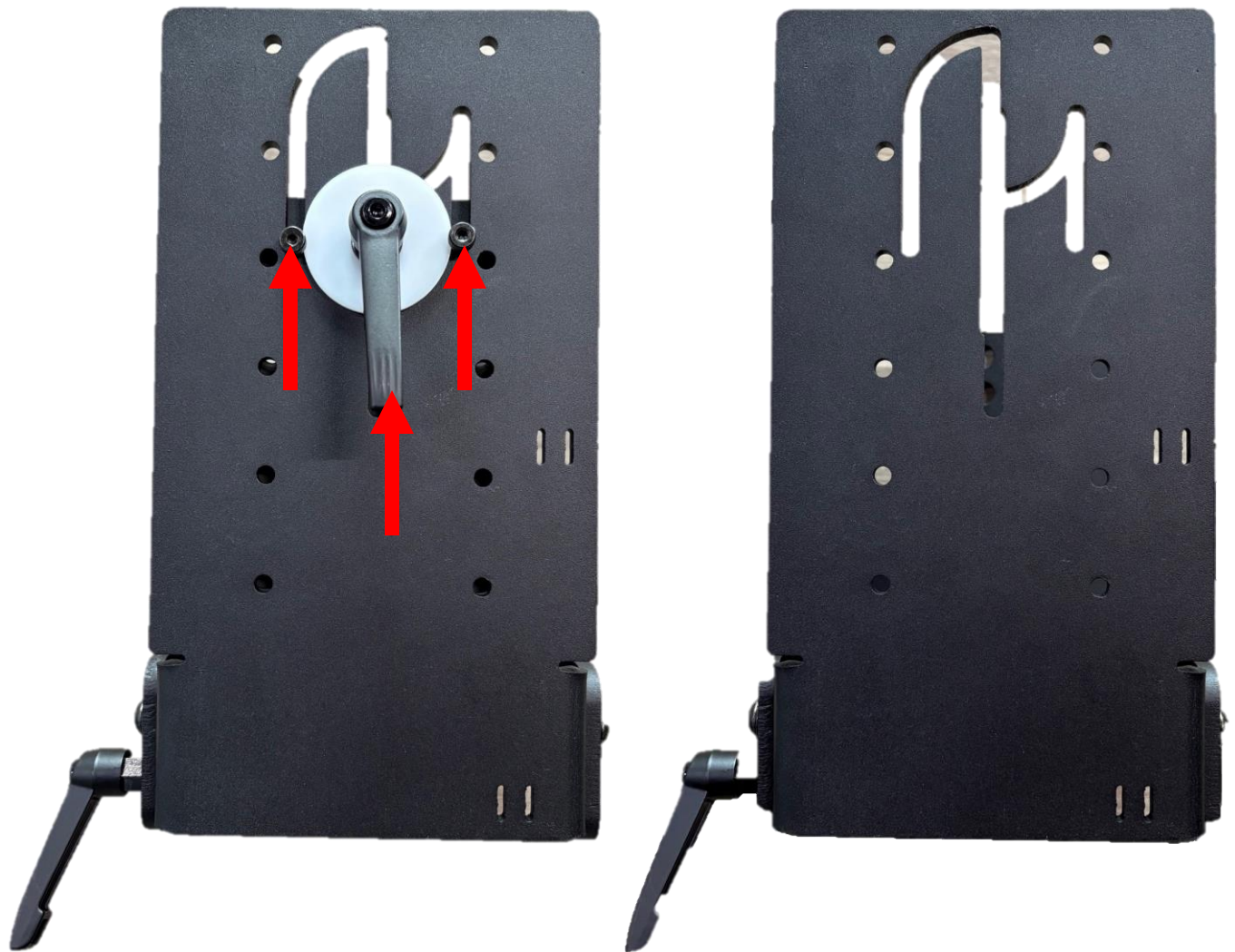

ASSEMBLY STEP 2

- Install and tighten the center bolt on the rotation plate based on what size tablet is being used.

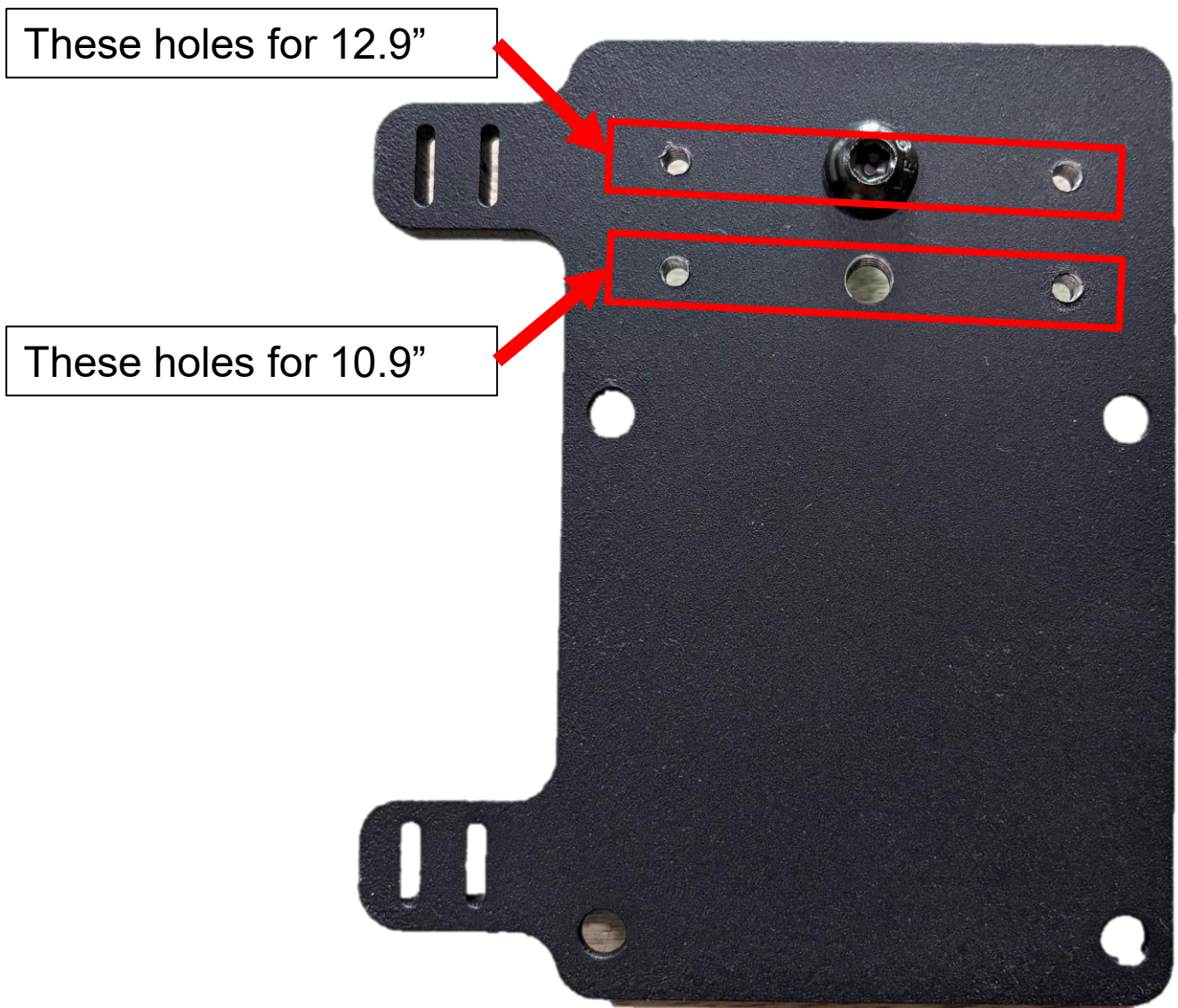

ASSEMBLY STEP 3

- Connect the rotation plate to the dock using the 4 provided flat head screws and secure cables in the locations shown below.

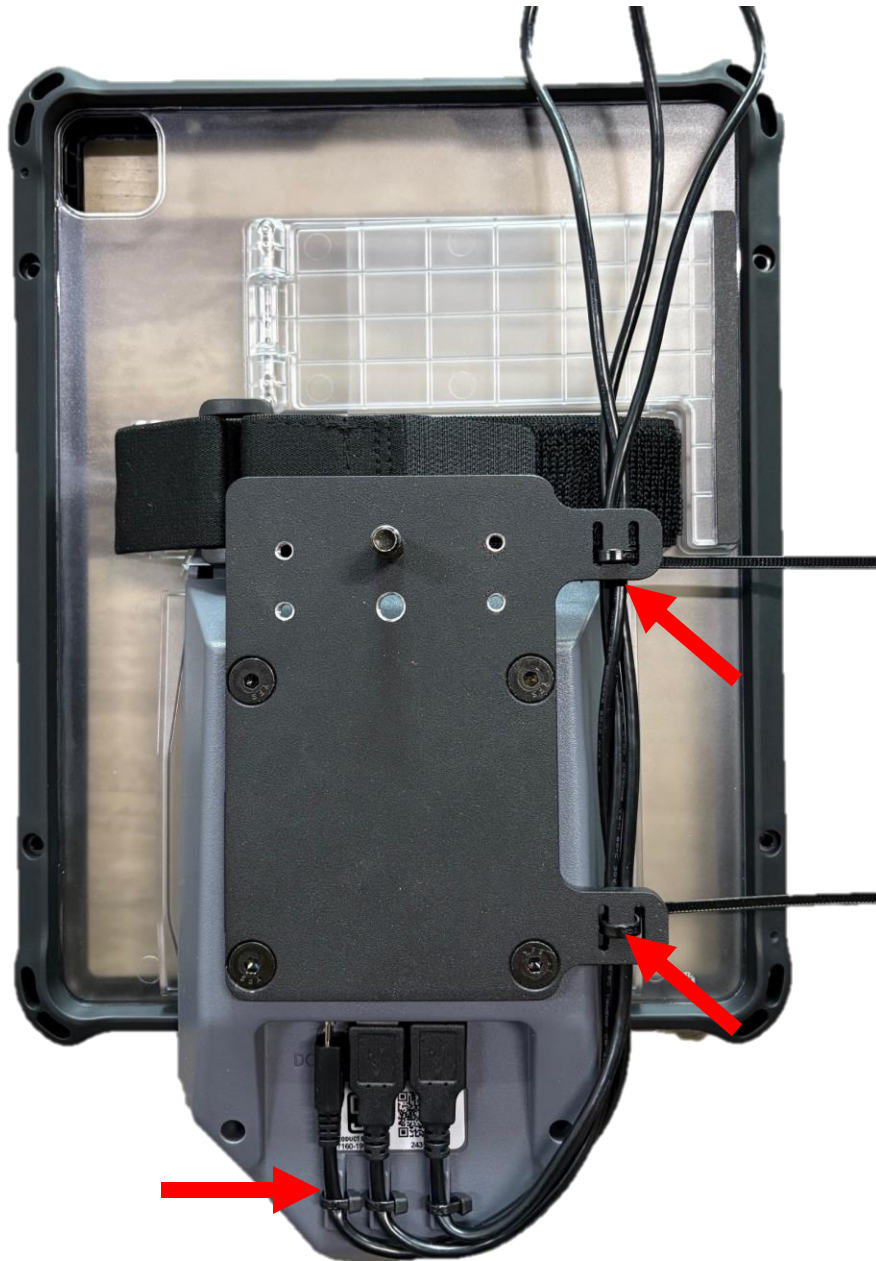

ASSEMBLY STEP 4

- Re-install the rotation plate to the mount with the supplied hardware as shown below

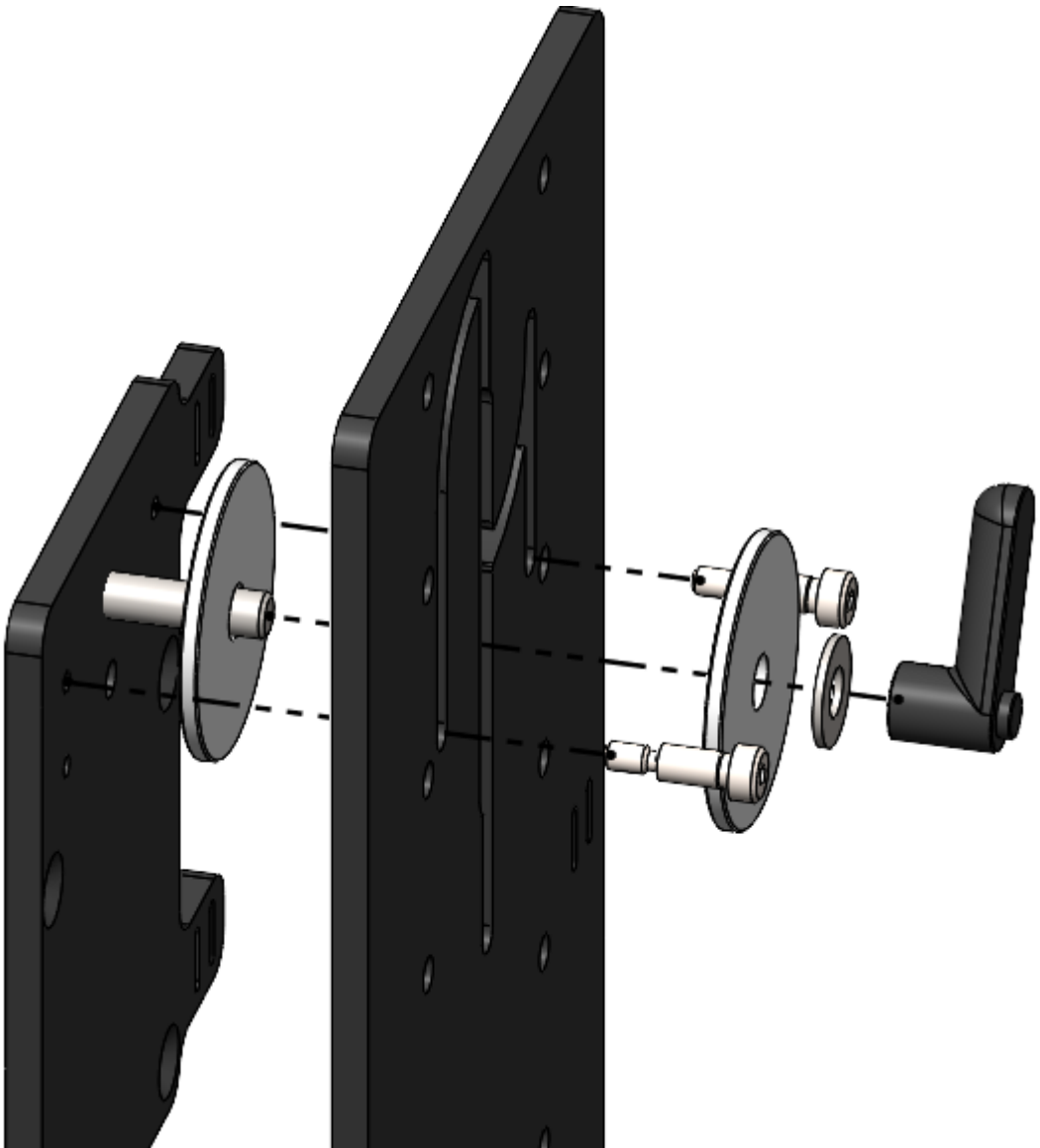

ASSEMBLY STEP 5

- Loosen the handle and raise the dock until it is in the upper most portrait position. Ensure the cables are not pulled tight and secure with cable ties as shown below.



OPERATION

- With the rear handle loosened, raise the dock all the way to the top of travel, rotate to desired position, lower dock the bottom of travel and tighten handle

